

Soils Map

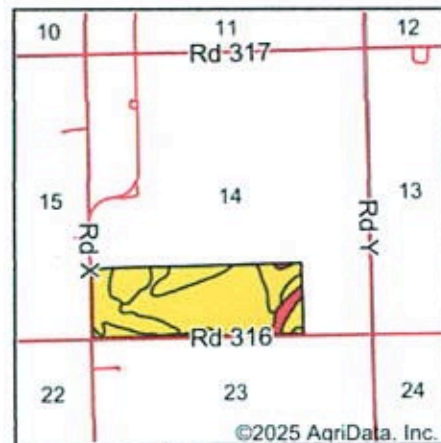
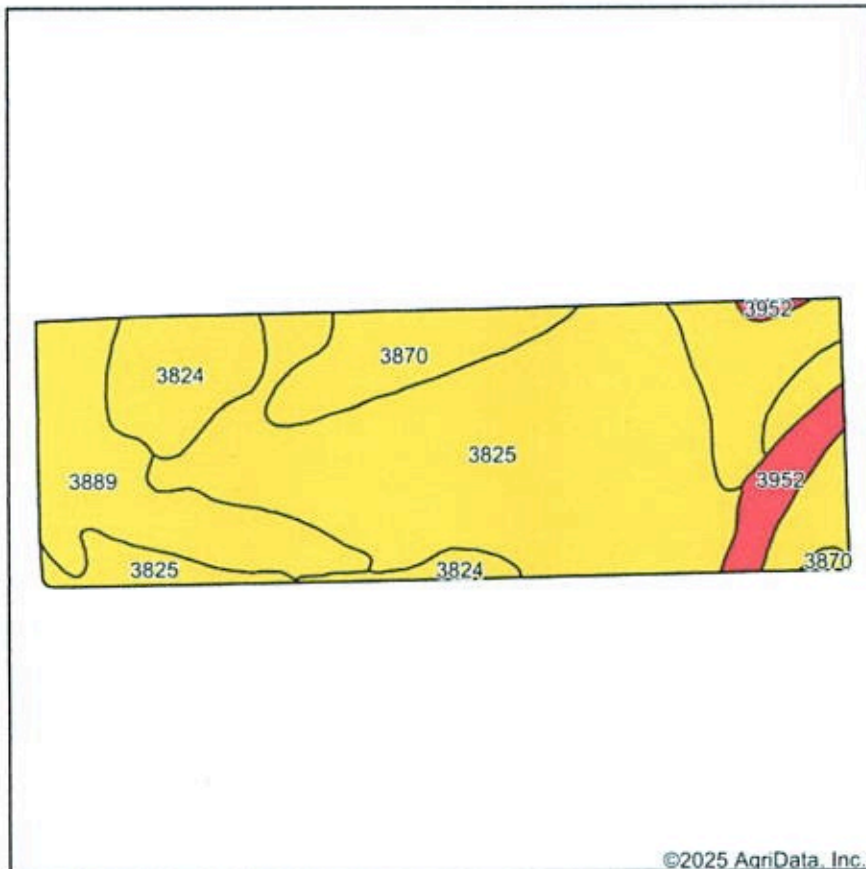

State: **Nebraska**
 County: **Clay**
 Location: **14-7N-5W**
 Township: **Sutton**
 Acres: **117.76**
 Date: **9/24/2025**

©2025 AgriData, Inc.

Maps Provided By

 CUSTOMIZED ONLINE MAPPING
 © AgriData, Inc. 2023 www.AgriDataInc.com



Soils data provided by USDA and NRCS.

Area Symbol: NE035, Soil Area Version: 26

Code	Soil Description	Acres	Percent of field	SRPG Legend	Restrictive Layer	Soil Drainage	Non-Irr Class *c	Irr Class *c	Range Production (lbs/acre/yr)	SRPG	*n NCCPI Overall
3825	Crete silt loam, 1 to 3 percent slopes	64.34	54.7%		> 6.5ft.	Moderately well drained	Ile	Ile	3375	64	63
3870	Hastings silty clay loam, 3 to 7 percent slopes, eroded	19.11	16.2%		> 6.5ft.	Well drained	IIle	IIle	3727	70	58
3889	Holder silty clay loam, 7 to 11 percent slopes, eroded	18.00	15.3%		> 6.5ft.	Well drained	IVe	IVe	3081	66	66
3824	Crete silt loam, 0 to 1 percent slopes	11.22	9.5%		> 6.5ft.	Moderately well drained	IIs	IIs	3240	67	63
3952	Fillmore silt loam, frequently ponded	5.09	4.3%		1.1ft. (Abrupt textural change)	Somewhat poorly drained	IIhw	IVw	3370	49	46
Weighted Average							2.51	2.55	3374.1	64.9	*n 61.9

*n: The aggregation method is "Weighted Average using all components"

*c: Using Capabilities Class Dominant Condition Aggregation Method

Soils data provided by USDA and NRCS.